

PCB Layout

Specification:

- Current Rating: 1 Ampere
- Insulation Resistance : 1000M ohms Min.
- Dielectric Withstanding : 300V AC
- Contact Resistance: 20m ohms Max.
- Operating temperature: -40 ° C to +105 ° C
- Material:
- Contact: Brass, Gold Flash or per Require
- Housing: Nylon6T UL 94V-0

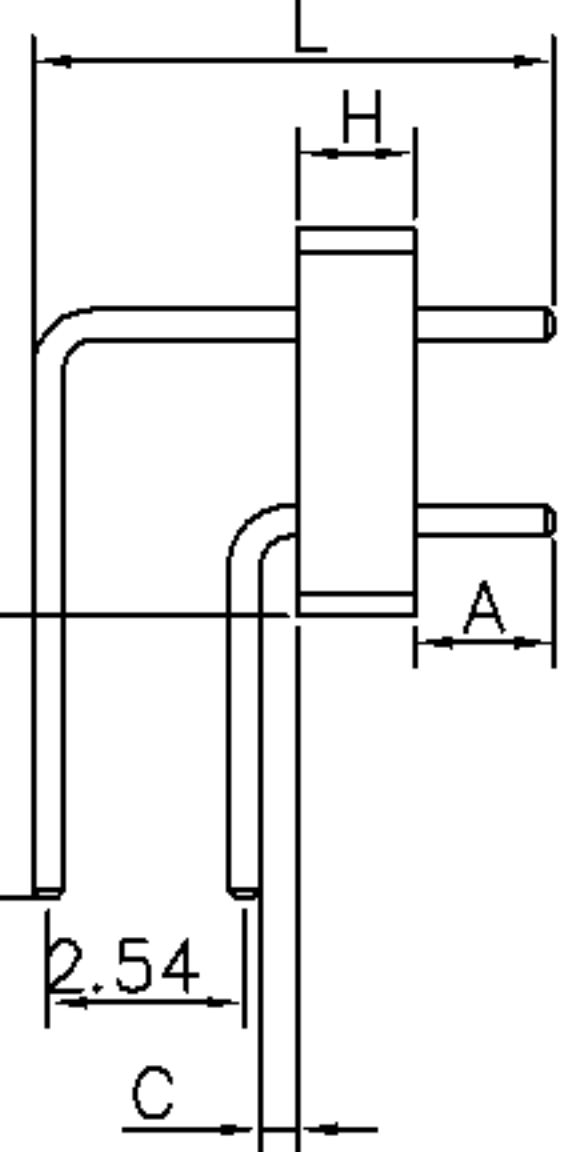

A、C、D、H、L的尺寸
可依客户要求订做

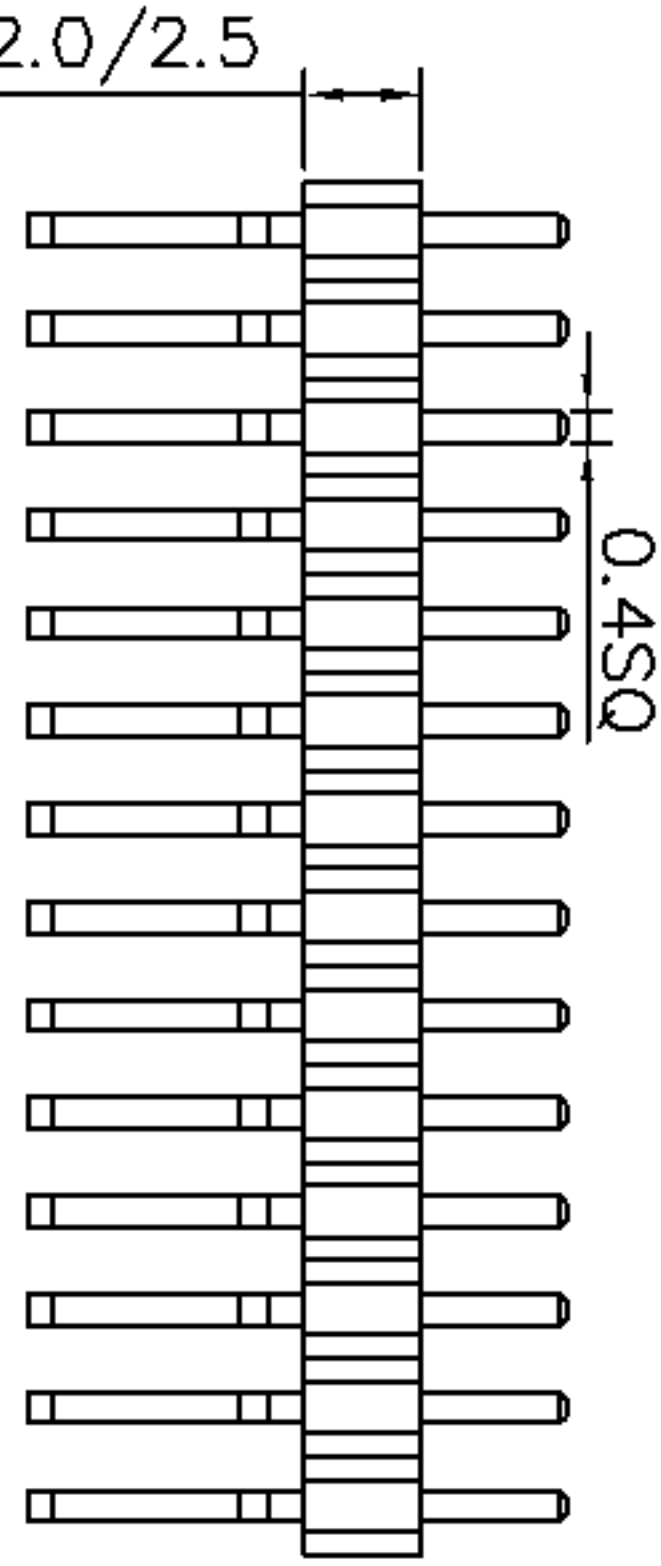

1101-427R22XX A2-H-L

1. 27PIN距双塑胶双
排弯式排针系列

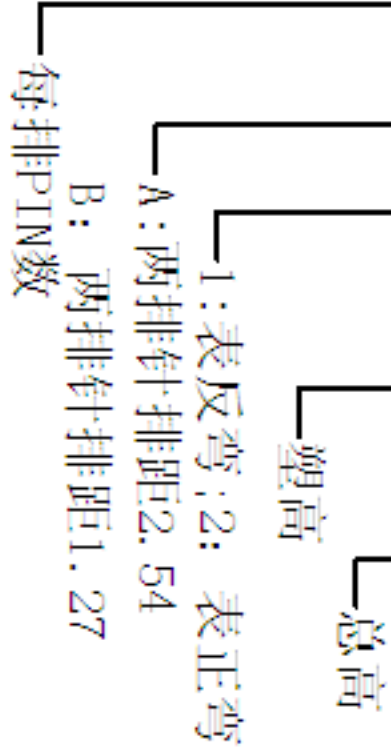

TOLERANCE		ANGLE
TOL		
ON		
XXX =	0.05	
XX =	0.15	1°
X -	0.20	2°
X. =	0.30	

DRAWN	DATE	CHECKED	DATE	TITLE
LZW	2011. 09. 07			排针系列-1. 27*2. 54PIN距-双排 双塑胶-弯式
CLIENT APPROVED DATE				RFQ NO
CLIENT APPROVED DATE				CLIENT P/N
CLIENT APPROVED DATE				UNIT : mm
CLIENT APPROVED DATE				SCALE: free
CLIENT APPROVED DATE				FILE NO. : YH20120526A007



武汉宇恒电子有限公司
WUHAN YUHENG ELECTRONIC CO., LTD

A				
	新版图	/	2011. 09. 07	LZW